

1560/20



1.5" DUAL RANGE NOZZLE

20/60 GPM

BILL OF MATERIALS

ASSY ITEM	PART NO.#	QTY	DESCRIPTION	MATERIAL
(A)	NZ-1-2	1	BUMPER	SANTOPRENE
(B)	NZ-15-4	1	SCREW,SHC,CRES	STAIN STL
(C)	O-010-TFE	1	O-RING,SCREW CAP	BUNA-70
(D)	NZ-15-1	1	CAP, TOP	6061-T6 ALUM
(E)	NZ-15-8	1	SEAL,SCREW CAP	TEFLON
(F)	NZ-15-7	1	CAP,BOTTOM	6061-T6 ALUM
(G)	NZ-15-2	1	TUBE,SPACER,60GPM	6061-T6 ALUM
(H)	O-121	1	O-RING,SLEEVE	BUNA-70
(J)	NZ-15-DR	1	SLEEVE,DUAL RANGE	6061-T6 ALUM
(K)	NZ-15-NH	1	BODY,INLET,1.5"	A356-T6 ALUM
(L)	G-15	1	GASKET,1.5"	SBR-70-BLACK
(M)	NZ-15-6	1	SPIDER	6061-T6 ALUM
(N)	NZ-15-5	1	NUT,SELFLOCKING,CRES	STAIN STL

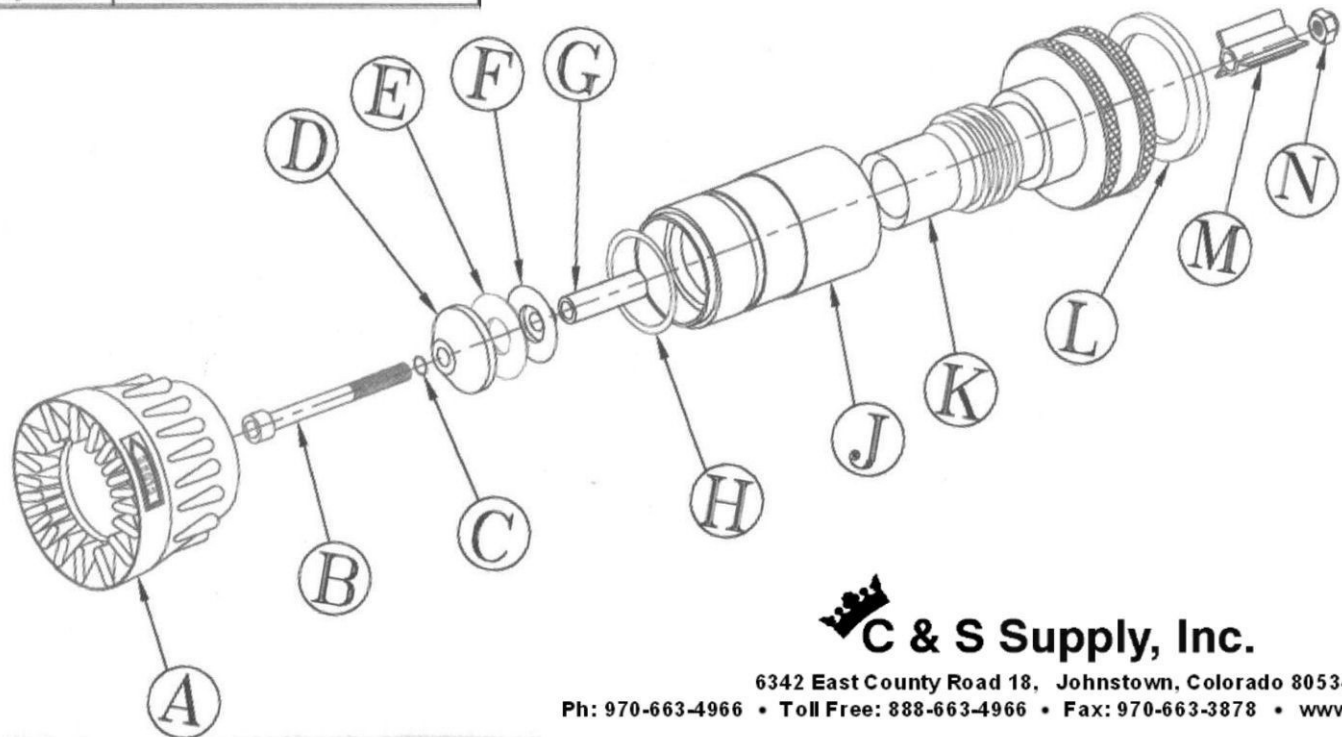

 **C & S Supply, Inc.**

6342 East County Road 18, Johnstown, Colorado 80534

Ph: 970-663-4966 • Toll Free: 888-663-4966 • Fax: 970-663-3878 • www.CSSupplyInc.com